

**HELU-S-RK-CU** Tubular cable lug - straight

uninsulated

**Tubular cable lug HELU-S-RK-CU**

Uninsulated tubular cable lugs in eye type design.

**Material**Socket: Copper according to DIN EN 13600  
Surface: tin plated**Technical data**

Temperature range: up to +120°C

**Note**

Also available in angulated version (45° and 90°).

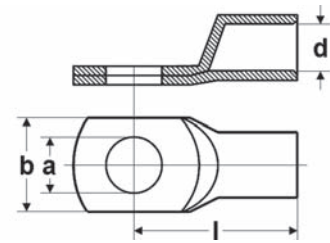
**Dimensions**

- a Diameter of the boring
- d Inner diameter of the cable insertion
- b Flange width
- l Length till middle of the boring

Part no.	Type	Cross-section mm <sup>2</sup>	a mm	d mm	b mm	l mm	Code type	Weight kg / 1000 items	Unit
907303	HELU-S-RK-CU 0,75-3	0,75	3,2	1,4	6,5	12,5	-	0,7	100
907304	HELU-S-RK-CU 0,75-4	0,75	4,3	1,4	8,5	14,0	-	0,8	100
907305	HELU-S-RK-CU 0,75-5	0,75	5,3	1,4	10,0	15,0	-	1,0	100
907306	HELU-S-RK-CU 1,5-3	1,5	3,2	1,9	6,5	14,0	-	1,2	100
907307	HELU-S-RK-CU 1,5-4	1,5	4,3	1,9	8,5	15,0	-	1,4	100
907308	HELU-S-RK-CU 1,5-5	1,5	5,3	1,9	10,0	16,0	-	1,5	100
907309	HELU-S-RK-CU 1,5-6	1,5	6,4	1,9	11,0	18,0	-	1,7	100
907310	HELU-S-RK-CU 2,5-4	2,5	4,3	2,4	8,5	15,0	-	1,6	100
907311	HELU-S-RK-CU 2,5-5	2,5	5,3	2,4	10,0	16,0	-	1,8	100
907312	HELU-S-RK-CU 2,5-6	2,5	6,4	2,4	11,0	18,0	-	1,9	100
907313	HELU-S-RK-CU 2,5-8	2,5	8,4	2,4	13,0	20,0	-	2,2	100
907314	HELU-S-RK-CU 4-4	4,0	4,3	3,0	8,5	17,0	-	2,2	100
907315	HELU-S-RK-CU 4-5	4,0	5,3	3,0	10,0	18,0	-	2,4	100
907316	HELU-S-RK-CU 4-6	4,0	6,3	3,0	11,0	20,0	-	2,6	100
907317	HELU-S-RK-CU 4-8	4,0	8,4	3,0	14,0	22,0	-	3,0	100

Dimensions and specifications may be changed without prior notice.