

HELU-S-RK-F-CU Tubular cable lugs for fine stranded wires - straight uninsulated



Tubular cable lug HELU-S-RK-F-CU

Uninsulated, straight tubular cable lugs in eye type design for fine stranded wires. The expanded sleeve facilitates cable inlet.

Material

Socket: Copper according to DIN EN 13600
Surface: tin plated

Technical data

Temperature range: up to +120°C

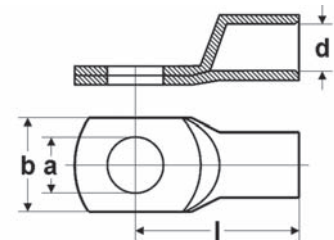

Dimensions

- a Diameter of the boring
- d Inner diameter of the cable insertion
- b Flange width
- l Length till middle of the boring

Part no.	Type	Cross-section mm ²	a mm	d mm	b mm	l mm	Code type	Weight kg / 1000 items	Unit
907409	HELU-S-RK-F-CU 10-5	10,0	5,3	5,0	12,0	23,0	-	7,0	100
907410	HELU-S-RK-F-CU 10-6	10,0	6,4	5,0	12,0	25,0	-	7,6	100
907411	HELU-S-RK-F-CU 10-8	10,0	8,4	5,0	15,0	28,0	-	8,9	100
907412	HELU-S-RK-F-CU 10-10	10,0	10,5	5,0	18,0	31,0	-	9,8	100
907413	HELU-S-RK-F-CU 10-12	10,0	13,0	5,0	20,0	32,0	-	10,0	100
907414	HELU-S-RK-F-CU 16-5	16,0	5,3	6,0	14,0	25,5	-	9,4	100
907415	HELU-S-RK-F-CU 16-6,4	16,0	6,4	6,0	14,0	27,0	-	10,0	100
907416	HELU-S-RK-F-CU 16-8	16,0	8,4	6,0	15,0	29,5	-	11,2	100
907417	HELU-S-RK-F-CU 16-10	16,0	10,5	6,0	18,0	32,0	-	11,2	100
907418	HELU-S-RK-F-CU 16-12	16,0	13,0	6,0	20,0	33,0	-	11,8	100
907419	HELU-S-RK-F-CU 25-6	25,0	6,4	7,7	16,0	32,0	-	14,7	100
907420	HELU-S-RK-F-CU 25-8	25,0	8,4	7,7	16,0	34,0	-	14,3	100
907421	HELU-S-RK-F-CU 25-10	25,0	10,5	7,7	18,0	35,0	-	15,3	100
907422	HELU-S-RK-F-CU 25-12	25,0	13,0	7,7	20,0	36,0	-	16,1	100
907423	HELU-S-RK-F-CU 25-16	25,0	17,0	7,7	26,0	40,5	-	19,1	100
907424	HELU-S-RK-F-CU 35-6	35,0	6,4	9,2	18,0	36,0	-	20,7	100
907425	HELU-S-RK-F-CU 35-8	35,0	8,4	9,2	18,0	36,0	-	20,7	100
907426	HELU-S-RK-F-CU 35-10	35,0	10,5	9,2	18,0	38,0	-	21,4	100
907427	HELU-S-RK-F-CU 35-12	35,0	13,0	9,2	23,0	40,0	-	22,2	100
907428	HELU-S-RK-F-CU 35-16	35,0	17,0	9,2	26,0	45,0	-	24,2	100
907429	HELU-S-RK-F-CU 50-6	50,0	6,4	11,2	22,0	42,0	-	32,5	100
907430	HELU-S-RK-F-CU 50-8	50,0	8,4	11,2	22,0	42,0	-	32,2	100
907431	HELU-S-RK-F-CU 50-10	50,0	10,5	11,2	22,0	43,0	-	33,3	100
907432	HELU-S-RK-F-CU 50-12	50,0	13,0	11,2	23,0	44,0	-	33,9	100
907433	HELU-S-RK-F-CU 50-14	50,0	15,0	11,2	25,0	45,5	-	36,0	100
907434	HELU-S-RK-F-CU 50-16	50,0	17,0	11,2	28,0	48,5	-	36,5	100

Continuation ▶