

HELU-S-PK-AL-DIN Tubular compression cable lugs

uninsulated

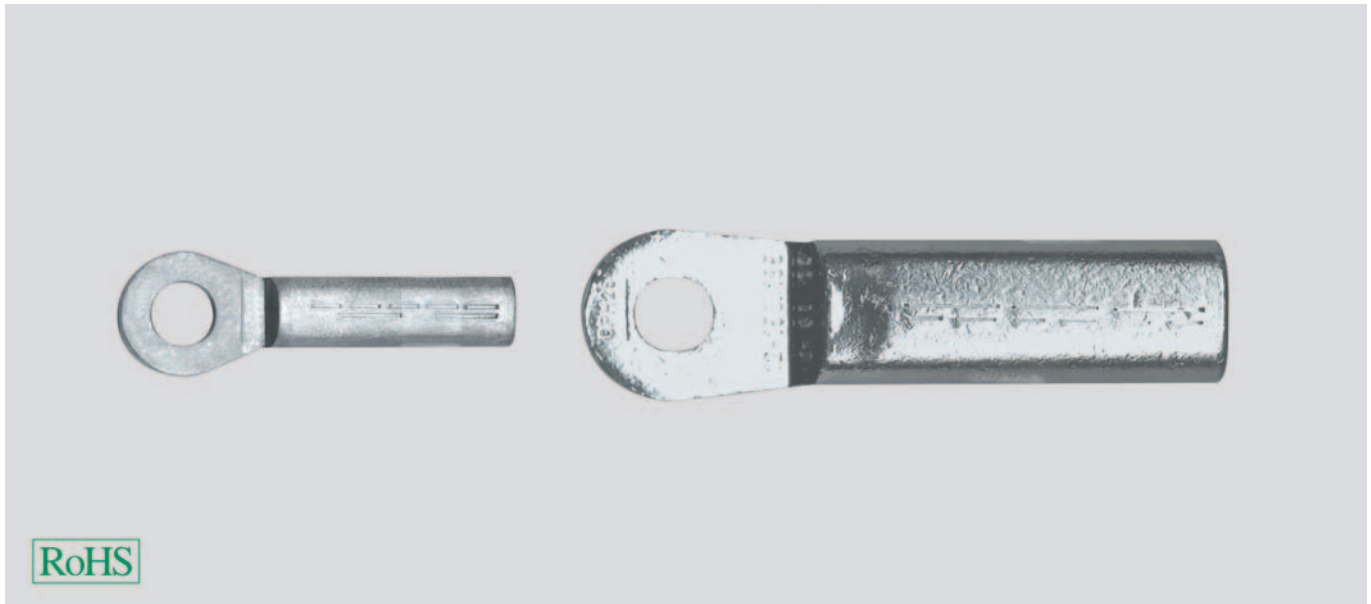

Tubular cable lug HELU-S-PK-AL-DIN

Uninsulated, straight tubular cable lugs in eye type design made by aluminum. High definition version for reliable crimping. Designed for conductor type RM acc. to DIN 48201 and circular reshaped conductors.

Material

AL 99,5
Surface: bare

Note

- Code type indicates the required hexagonal clamping insert.
- Sleeves are prefilled with compound and sealed with plastic plugs

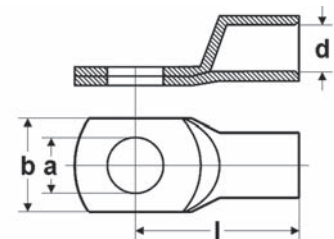

Dimensions

- a Diameter of the boring
d Inner diameter of the cable inclusion
b Flange width
l Length till middle of the boring

Part no.	Type	Cross-section RM/SM - SE mm ²	a mm	d mm	b mm	l mm	Code type	Weight kg / 1000 items	Unit	
907865	HELU-S-PK-AL-DIN 16-8	16,0 - 25,0	8,4	5,6	16,0	52,0	12	9,6	50	-
907866	HELU-S-PK-AL-DIN 16-10	16,0 - 25,0	10,5	5,6	18,0	52,0	12	9,7	50	-
907867	HELU-S-PK-AL-DIN 25-8	25,0 - 35,0	8,4	6,8	16,0	60,0	12	14,8	50	-
907868	HELU-S-PK-AL-DIN 25-10	25,0 - 35,0	10,5	6,8	18,0	60,0	12	15,3	50	-
907869	HELU-S-PK-AL-DIN 35-8	35,0 - 50,0	8,4	8,0	20,0	67,0	14	24,5	50	-
907870	HELU-S-PK-AL-DIN 35-10	35,0 - 50,0	10,5	8,0	20,0	67,0	14	24,5	50	-
907871	HELU-S-PK-AL-DIN 35-12	35,0 - 50,0	13,0	8,0	20,0	67,0	14	23,5	50	-
907872	HELU-S-PK-AL-DIN 50-8	50,0 - 70,0	8,4	10,0	23,0	74,0	16	32,9	25	-
907873	HELU-S-PK-AL-DIN 50-10	50,0 - 70,0	10,5	10,0	23,0	74,0	16	28,8	25	-
907874	HELU-S-PK-AL-DIN 50-12	50,0 - 70,0	13,0	10,0	23,0	74,0	16	33,8	25	-
907875	HELU-S-PK-AL-DIN 70-10	70,0 - 95,0	10,5	11,5	28,0	84,0	18	47,7	25	-
907876	HELU-S-PK-AL-DIN 70-12	70,0 - 95,0	13,0	11,5	28,0	87,0	18	47,3	25	-
907877	HELU-S-PK-AL-DIN 95-10	95,0 - 120,0	10,5	13,2	32,0	90,0	22	70,1	10	-
907878	HELU-S-PK-AL-DIN 95-12	95,0 - 120,0	13,0	13,2	32,0	90,0	22	78,2	10	-
907879	HELU-S-PK-AL-DIN 95-16	95,0 - 120,0	17,0	13,2	32,0	90,0	22	76,2	10	-
907880	HELU-S-PK-AL-DIN 120-10	120,0 - 150,0	10,5	14,7	32,0	98,0	22	83,8	10	-
907881	HELU-S-PK-AL-DIN 120-12	120,0 - 150,0	13,0	14,7	32,0	98,0	22	87,9	10	-
907882	HELU-S-PK-AL-DIN 120-16	120,0 - 150,0	17,0	14,7	32,0	98,0	22	86,4	10	-
906459	HELU-S-PK-AL-DIN 150-10	150,0 - 185,0	10,5	16,3	35,0	104,0	25	99,8	10	-
906436	HELU-S-PK-AL-DIN 150-12	150,0 - 185,0	13,0	16,3	35,0	104,0	25	102,3	10	-
906461	HELU-S-PK-AL-DIN 150-16	150,0 - 185,0	13,0	16,3	35,0	104,0	25	100,8	10	-
906462	HELU-S-PK-AL-DIN 150-20	150,0 - 185,0	21,0	16,3	35,0	104,0	25	100,2	10	-
907883	HELU-S-PK-AL-DIN 185-10	185,0 - 240,0	10,5	18,5	40,0	109,0	28	133,9	10	-
906463	HELU-S-PK-AL-DIN 185-12	185,0 - 240,0	13,0	18,5	40,0	109,0	28	133,9	10	-
906464	HELU-S-PK-AL-DIN 185-16	185,0 - 240,0	17,0	18,5	40,0	109,0	28	137,5	10	-
906465	HELU-S-PK-AL-DIN 185-20	185,0 - 240,0	21,0	18,5	40,0	109,0	28	137,5	10	-
907884	HELU-S-PK-AL-DIN 240-10	240,0 - 300,0	10,5	21,0	46,0	119,0	32	182,8	10	-
906466	HELU-S-PK-AL-DIN 240-12	240,0 - 300,0	13,0	21,0	46,0	119,0	32	179,4	10	-
906467	HELU-S-PK-AL-DIN 240-16	240,0 - 300,0	17,0	21,0	46,0	119,0	32	176,2	10	-
906468	HELU-S-PK-AL-DIN 240-20	240,0 - 300,0	21,0	21,0	46,0	119,0	32	179,0	10	-
906469	HELU-S-PK-AL-DIN 300-12	300,0 - 25,0	13,0	23,3	50,0	125,0	38	205,4	5	-
906470	HELU-S-PK-AL-DIN 300-16	300,0 - 25,0	17,0	23,3	50,0	125,0	38	201,4	5	-
906471	HELU-S-PK-AL-DIN 300-20	300,0 - 25,0	21,0	23,3	50,0	125,0	38	194,3	5	-
906472	HELU-S-PK-AL-DIN 400-12	400,0 - 25,0	13,0	26,0	55,0	120,0	38	283,0	5	-
906473	HELU-S-PK-AL-DIN 400-16	400,0 - 25,0	17,0	26,0	55,0	120,0	38	273,3	5	-
906474	HELU-S-PK-AL-DIN 400-20	400,0 - 25,0	21,0	26,0	55,0	120,0	38	240,0	5	-
906475	HELU-S-PK-AL-DIN 500-12	500,0 - 25,0	13,0	29,0	63,0	140,0	44	380,0	5	-
906476	HELU-S-PK-AL-DIN 500-16	500,0 - 25,0	17,0	29,0	63,0	140,0	44	378,0	5	-
906477	HELU-S-PK-AL-DIN 500-20	500,0 - 25,0	21,0	29,0	63,0	140,0	44	373,5	5	-

Dimensions and specifications may be changed without prior notice.